

portfolio

content

others

invisible city_valdrada P38

NCTU BUS STOP_2010(with chan zhi ene) P40

..Chang Chung-yi.....

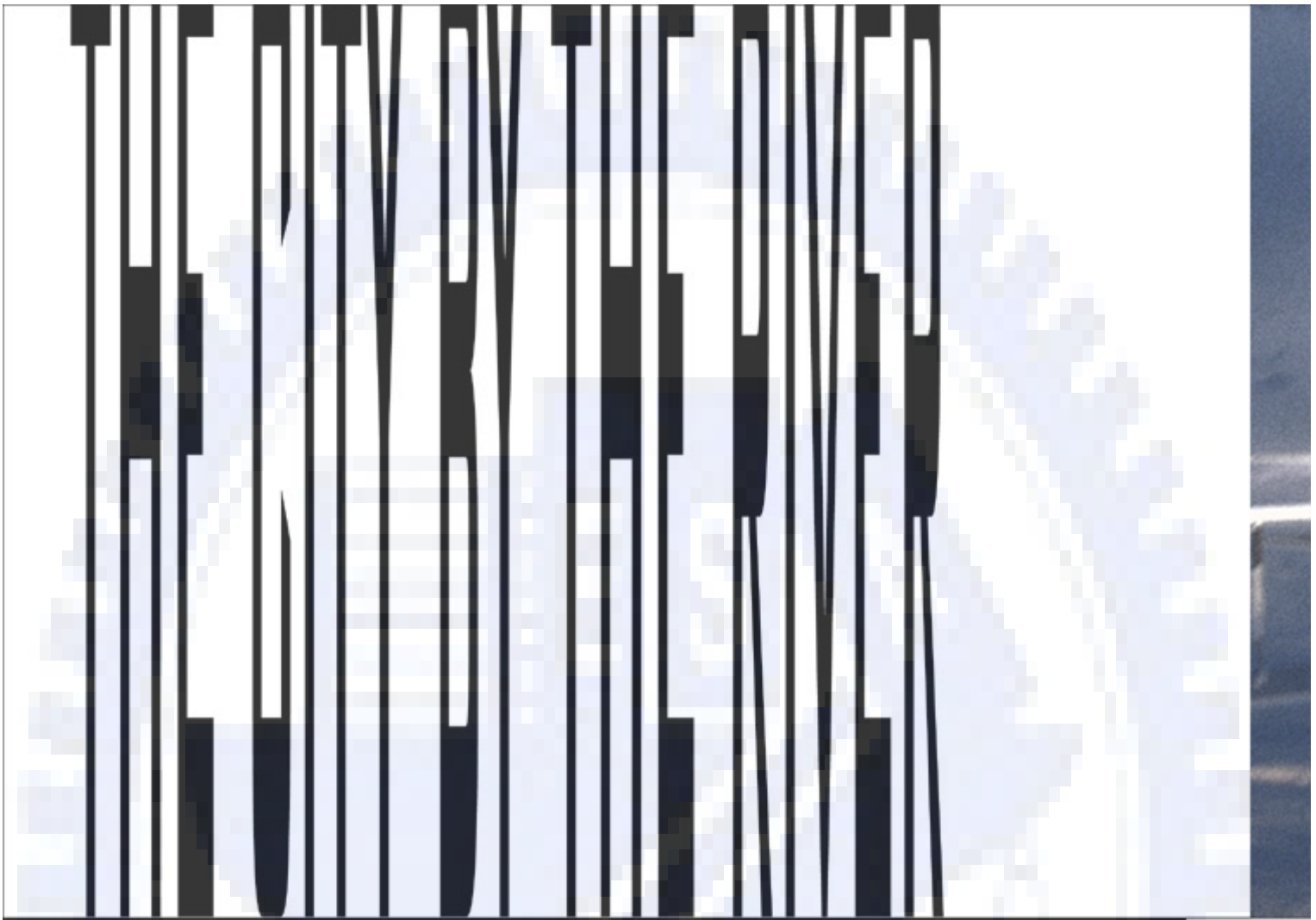

DESIGN STUDIOS

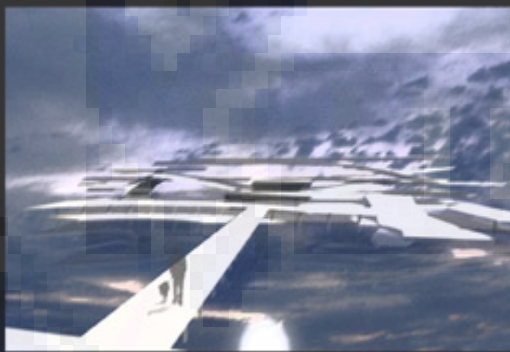

Cities & Eyes

The ancients built Valdrada on the shores of a lake, with houses all verandas one above the other, and high streets whose railed parapets look out over the water. Thus the traveler, arriving, sees two cities: one erect above the lake, and the other reflected, upside down. Nothing exists or happens in the one Valdrada that the other Valdrada does not repeat, because the city was so constructed that its every point would be reflected in its mirror, and the Valdrada down in the water contains not only all the flutings and juttings of the facades that rise above the lake, but also the rooms' interiors with ceilings and floors, the perspective of the halls, the mirrors of the wardrobes.

- ITALO CALVINO -



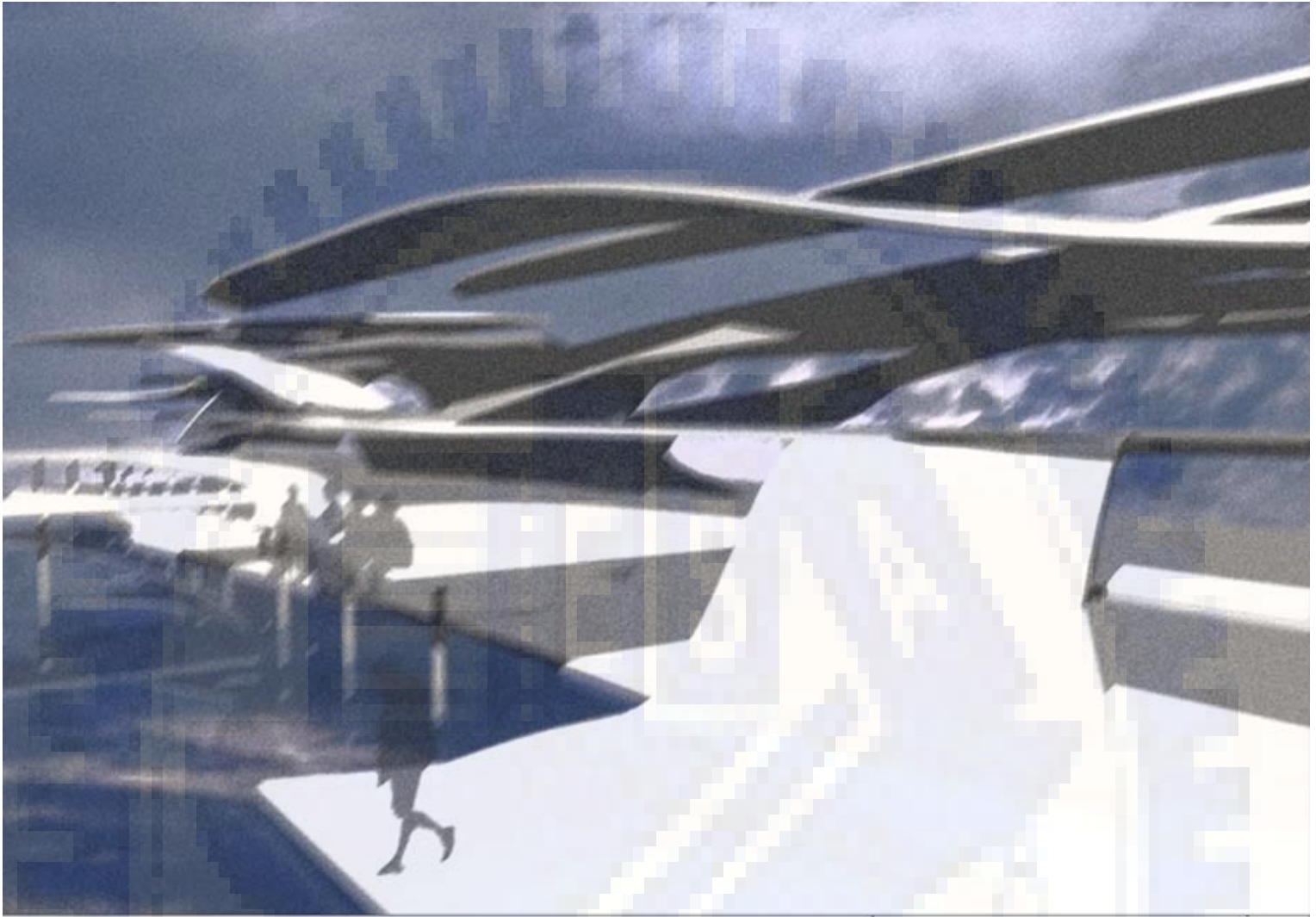

advise professor : Kris Yao

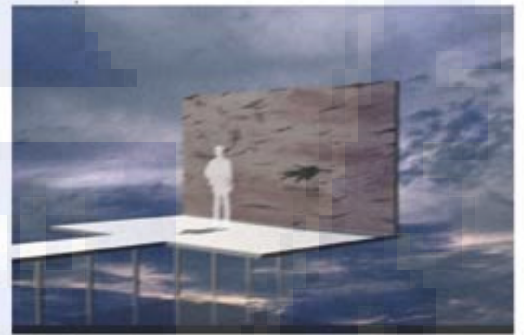

MEDIA STUDIOS



公車站主體遮蔽物以水波紋路為靈感，不以自由曲線而以折線做為基本架構，強調出主體獨特性。

利用風的流動性導入而使之膨脹帶來動態的視覺感，並在夜晚，為主體外部與內部照明成為竹湖附近顯著的地標。

FUTURE BUS STOP

1. 資訊空間---提供地方定位,網路查詢,資訊傳播等功能
2. 等車空間---同時提供資訊網路插座,可用手機下載各種資訊
3. 團體空間---多人座位,面對竹湖和樹林美景.





在材質上使用透明與帆布
利用陽光及樹影投影於
折板骨架中產生錯落的影子
與竹湖周遭環境相呼應

